

COLOQUICK

A BETTER FUTURE

PASTEUR UNIT

ASSEMBLY GUIDE



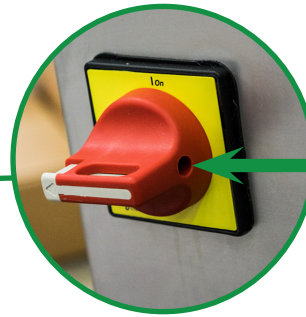
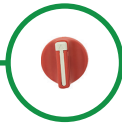

1 Room temperature



Max: 40 °C
104°F

Min: 5 °C
40 °F

2 Place close to a drain

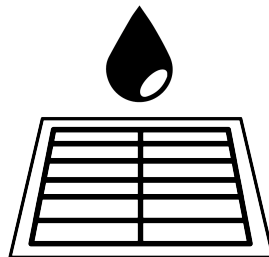

3 Place on even surface

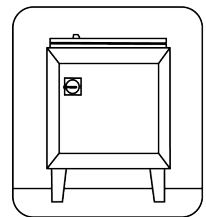
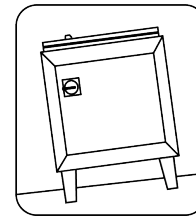

4 Connect the PASTEUR unit to the cold water tap.

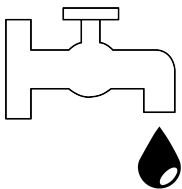

Water temperature

Max. 40 °C

Max. 104 °F

5 Power connection

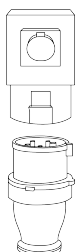

Connect the PASTEUR unit to the correct power source. Any new installations should be performed by professionals.

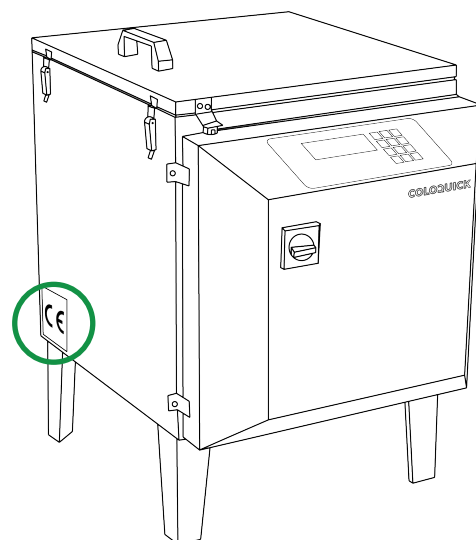

View the CE marking for correct information on power source.